



Refund Policy

Thank you for your purchase! We hope you are happy with your purchase. If you are not satisfied with your purchase for any reason, you may return the product to us for a full/partial refund or an exchange. Please find our Refund Policy below for more information.

Eligibility for Refunds and Exchanges

- The item to be returned must be unused and in the same condition that you received it.
- To complete the return process, and issue a refund, a receipt or proof of purchase must be provided.
- If the item in question was marked as a gift when purchased and shipped directly to you, you will receive a gift credit for the value of your return.,
- All items to be returned and refunded must be returned within 14 days, including sale items and items purchased with promotional discounts.
- All items excluding the items that are marked as gifts will be issued to the original payment method and in the original tender currency (unless otherwise stated).

Refund Exceptions for Purchases

The following items cannot be returned;

- Trading cards, trading card accessories (e.g. Sport cards, Pokemon cards, trading card binders),
- Open of defective collectibles,
- Personalized items and digital downloads,
- Opened/unsealed hygiene products.

For defective or damaged products, please contact us to arrange a refund or exchange.

Return Process

- To return an item, place the item securely in its original packing and include your proof of purchase, then please mail your return to the address below;

123 Maple Street Anytown, PA 17101

- You may also use the prepaid shipping label provided by us enclosed with your package. Return shipping charges will be paid or reimbursed by us.
- Please do not send the item back to the manufacturer. The items should be returned to the address given above.

Refund Times

Refund Method	Refund Time (After Refund is Processed)
Credit Card	Three to five business days
Gift Card	Two to three hours
Debit Card	Up to 10 business days
Checking Account	Up to 10 business days
SNAP EBT Card	Up to 10 business days
Gift Card Balance	Two to three hours
Promotional Certificate	No refund issued
Shop with Reward Points	Up to five business days
Pay in Cash	Up to 10 business days
Pre-paid Credit Card	Up to 30 days

Partial Refunds or Restocking Fees

Item	Refund
Items in original condition past the return window	80% of the item price
Opened CDs, DVDs, VHS tapes, cassette tapes, or vinyl records (taken out of its plastic wrap)	50% of the item price
Items with damage, missing parts, not in original condition, or that have obvious signs of use for reasons not due to a seller error	Up to 50% of the item price
Open software or video games for reasons not due to a seller error	0% of the item price

Questions

If you have any questions concerning our return policy, please contact us at;

COMPANY NAME

123 Maple Street Anytown, PA 17101

info@example.com

www.example.com

(123) 1234567

Full Name

Signature



Thanks for using **Refund Policy Template!** To edit this PDF with **Jotform Sign**, sign up for a free Jotform account today.

[EDIT PDF](#)

Learn More About Jotform PDF Products

Jotform offers powerful PDF solutions. Check them out below.

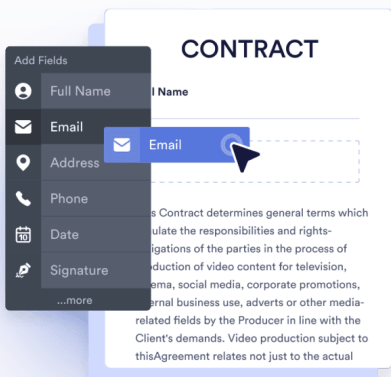

JOTFORM PDF EDITOR

Turn form submissions into PDFs automatically — ready to download or save for your records.

[Go to PDF Editor >](#)

SMART PDF FORMS

Convert your PDF files into online forms that are easy to fill out on any device.

[Go to Smart PDF Forms >](#)

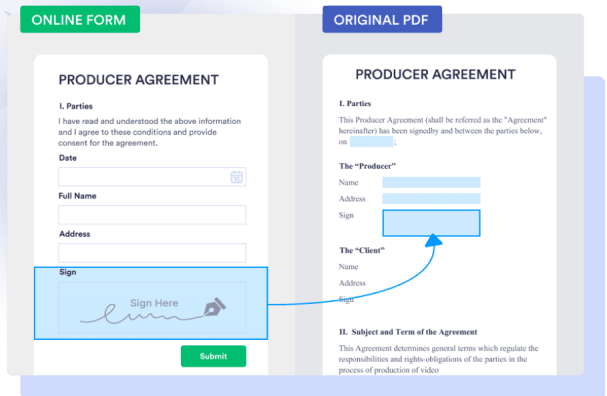

JOTFORM SIGN

Collect e-signatures with Jotform Sign to automate your signing process.

[Go to Jotform Sign >](#)

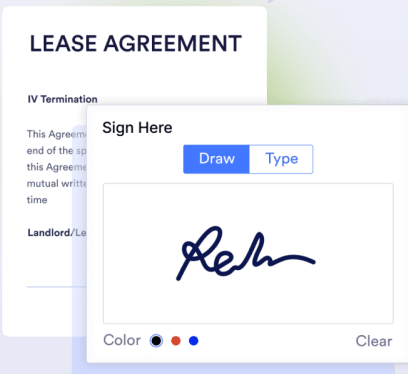

These templates are suggested forms only. If you're using a form as a contract, or to gather personal (or personal health) info, or for some other purpose with legal implications, we recommend that you do your homework to ensure you are complying with applicable laws and that you consult an attorney before relying on any particular form.